

I G A



The city newsletter

Also available online at <http://www.mie-iifa.jp/>

この情報紙は『広報いが市』などから記事を選んで載せています。

Articles published in this newsletter are taken from the bimonthly "Kouho Iga shi" and other publications

Population of Iga City	96,442
Foreign nationals	4,233
4.39% of population	
28th February 2014	

NINJA Festival にんじゃフェスタ2014

On Saturdays, Sundays and Public Holidays during the NINJA FESTA season you will be able to transform into a ninja on the fifth floor of Haitopia Iga and visit six different ninja dojos around town. You can choose between red, blue, even pink and other colours for your own ninja costume. At the dojo, you can get a taste of being a ninja by trying various types of ninja training including shuriken (ninja stars) and blow darts. There are also prizes for those who can successfully spot all the ninja secretly hiding around town, and many other events taking place throughout the festa season. Ninja costumes will also be available for rent on weekdays, too. Enjoy this unique season in the Iga calendar. Come along, dress up, and become a ninja!

How to enjoy Ninja Festa!

ONE : Transform into a ninja at one of the sites around town!

TWO : Hone your ninja skills at one of the dojo around town!

THREE : Find all the ninja hiding around town as you make your way between all the dojo!

How to use a *dofu* You will receive a *dofu* at any of the dojo you go to when you arrive. One *dofu* is redeemable to the value of 500 yen, and can be used at any of the cooperating shops or restaurants around town.

Enquiries: Tourism Strategy Dept. TEL0595-22-9670 FAX0595-22-9695

Official Website <http://www.iga.ne.jp/ninjafesta> Facebook Page <http://www.facebook.com/ninjafesta>

MORE! Check file



PREFECTURAL HOUSING APPLICATIONS NOW OPEN

けんえい じゅうたくの もうしこみ

Application Period: April 2014

Eligibility:

- 1 – You must live or work in Mie Prefecture.
- 2 – Be in difficulty with your living conditions.
- 3 – Have family members who will be living with you, or plan to do so
 - Fianceses can apply, provided they register their marriage within 3 months of moving in
 - Common-law couples can apply, provided they are not registered as married
- 4 – Have a salary within the standard range designated by the Municipal Residence Law.
- 5 – Must have no outstanding bills in rent, car parking etc if you already live in prefectural housing.
- 6 – Not be behind in any tax payments
- 7 – You must have two guarantors

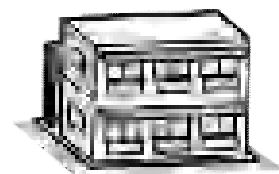

Note: Single mother families, families with elderly or disabled members are considered as priorities for housing. Please provide the necessary paperwork proving your current family situation if this applies to you.

If you have applied for prefectural housing in the past but been rejected 3 times, you can apply for preferential treatment. Please read the booklet outlining the rules for prefectural housing. You can receive an application form and rules booklet from the prefectural building in Ueno (ken chousha) or in City Hall's Shimin Seikatu Ka.

Prefectural Housing

[Iga Block] **2 Casa Ueno** (Regular Occupant)

Enquiries: Mie-ken Kendo Seibibu Juutaku Ka. TEL059-224-2703

MANTHLY TAX PAYMENTS (4がつのうぜい)

Pay by April 30th Fixed Assets Tax [Kotei Shisan ze]
Shuu Zei Ka TEL 0595-22-9612

Routine Vaccinations Period: 1st April 2014

		Eligible Age	Doses	Note
Hibbs		2 mnths ~ 5 yrs	1~4	Number of doses may change based on when immunisation begins. Speak to the doctor for confirmation.
Streptococcus Pneumoniae		2 mnths ~ 5 yrs	1~4	
Combined Shot Diphtheria Whooping Cough Tetanus Polio	1 st dose in first stage	3 mnths ~ 7.5 yrs	3	Between 3mnths and 1yr, 3 shots spread within 3-8 weeks.
	Additional dose in first stage	12~18 mnths after 1 st dose until 7.5 yrs of age	1	Immunity increases with a booster shot 1~1.5 yrs after third dose.
	* Since September 2012 an inactivated polio vaccination has been introduced. Since November 2012, a 4 compound vaccination has been introduced. * Those taking the DPT 3 compound need 4 shots, those taking the inactivated polio vaccination also need 4 shots.			
BCG		Under 12 mnths	1	Take between 5 ~ 8 mnths after birth.
Mashin MR	First stage	1~2 yrs of age	1	Take as early as possible after first birthday.
	Second stage	Born between April 2 2007 and April 1 2009	1	You will receive a notification by post. Please get the vaccination as early as possible.
Japanese Encephalitis	1 st dose first stage	3 ~ 7.5 yrs	2	Two doses within 1~4 weeks of each other between 3 ~ 4 yrs of age.
	Additional dose in first stage	Take 1yr after first dose before 7.5yrs of age.	1	Take about one year after first dose.
	Second stage	9 ~ 13 yrs of age	1	Take as soon after 9 th birthday as possible.
	* Those born between April 2 1995 ~ April 1 2007 who have not completed the first and second stages can receive any outstanding shots (but second stage must be 9 yrs of age or older).			
DT	Between 11 ~ 13 yrs of age		1	Notification will be sent by post to those in 6 th grade of elementary school.
Cervical Cancer	Girls between 6 th grade of elementary school ~ 1 st grade of senior highschool.		3	3 doses within 6 months of one another.

Caution:

- Make sure you check the dates and times for vaccinations. Make a reservation for your vaccination in advance.
- Vaccinations are free. However, you will have to pay if you take the vaccination outside Mie Prefecture.
- On the day of your vaccination, bring your mother child notebook and preliminary check-up slip.
- If you do not have a preliminary check-up slip, you can obtain one at a local clinic or hospital in Iga. If you wish to have the vaccination outside of Iga, please contact us to receive a preliminary check-up slip in advance.
- These vaccinations can be received in designated clinics and hospitals within Mie Prefecture.

Enquiries: Kenkou Shuihin Ka TEL0595- 22-9653

Financial Support System for School-goers しゅうがく えんじょ せいど

Iga City can provide some financial support to those who have difficulties with school-related costs such as school meal fees, school materials etc. If you wish to access this support, you must apply for it. The support is only offered on an annual basis, so you have to apply for it every year. If you receive the support this year, you do not automatically receive it again next year.

* Support will not be available where it coincides with support available under welfare support.

Eligibility: Guardians of students enrolled in a municipal elementary or junior high school. *Income thresholds apply.

Apply to: the school your child is enrolled in.

Payments: 3 times a year (July, December and March) Enquires: Gakkou Kyouiku Division TEL 0595-47-1282



Registering your dog and rabies vaccinations きょうけんびょう よぼう ちゅうしゃ

Registering your dog and rabies vaccinations

Get your dog vaccinated

Dog owners are bound by law to have their dog vaccinated every year between April 1st and June 30th. This vaccination is available at any vets in Iga, or at certain venues run by the city with the cooperation of the Mie Vets Association.

If your dog is already registered and only needs a rabies shot – 3200 yen

Registering your dog at the same as getting a rabies shot – 6200 yen (3200 fee for the shot and 3000 fee for dog registration).

Please being the exact amount as change may not be available.

Enquiries: Shimin Seikatsu Ka TEL0595-22-9638 FAX0595-22-9641

Infant Health Checkups & Development Tests (あかちゃんのけんしん) Kenkou Suishin Ka TEL 0595-22-9653

In Iga, checkup examinations are available at 18 months (children up until 21 months can take it) and 3 years (for children up to 3 years and 9 months of age). Notifications will be sent out to homes with children eligible for the checkups. These notifications will be in Japanese, so please bring your letter along with you to City Hall if you need help understanding its content.

18 month Checkup (free)

This is a very important period in your child's development of basic functions such as speech, walking and so on, so the 18 month checkup is a general examination. Your child will be observed day by day to assess his or her emotional and physical development. Make use of this free checkup to make sure your child has a healthy upbringing.

【Examinations】 Measuring weight, height, medical checkup, hearing test, reflexes, advice on dental health and nutrition.

【Bring】 Mother-Child passbook (*Boshi techo*), forms

【Date】 15th April (Tues) from 12:50 to 14:30 (Place: Iga Ishi Kaikan – in front of the police station)

* Also available at City Hall sub-branches. Contact them directly for further information.

3 years (free)

This is the time when a child is becoming aware of his or herself and beginning the important process of independence from their mother. A more detailed evaluation will be carried out, including checks of physical and psychological development, as well as teeth, hearing and vision. Aside from observing your child's development, the 3 year exam is also a chance for families with children to talk with and socialize with one another.

【Examinations】 Urine exam, measuring weight and height, medical checkup, dental checkup, reflex development test, advice on dental health and nutrition.

【Bring】 Mother-Child passbook (*Boshi techo*), forms, completed questionnaire on hearing and vision, urine sample

【Date】 17th April (Thurs) from 12:50 to 14:30 (Place: Iga Ishi Kaikan – in front of police station)

* Also available at City Hall sub-branches. Contact them directly for further information.

Emergencies & Medical Assistance (きゅうきゅう・いりょう) Iryou Fukushi Seisaku Ka TEL.0595-22-9705

If possible, see your regular doctor during normal clinic opening hours.

Choose a regular clinic to go to when you need to see a doctor.

What should you do if you fall sick suddenly, or are sick on a day when the clinic you go to is closed?

- Contact a health clinic (*shinryou sho*) or emergency clinic (*oukyuu shinryou jo*).

Iga shi Emergency Clinic TEL 0595-22-9990

【Place】 Iga shi Ueno Kayamachi 1615 (Behind Okanami Hospital)

【Specializations】 General and pediatrics * Injuries and minor illnesses (first aid)

Monday to Saturday	2 0 : 0 0 ~ 2 3 : 0 0
Sundays, public	9 : 0 0 ~ 1 2 : 0 0
holidays, year end	1 4 : 0 0 ~ 1 7 : 0 0
holidays	2 0 : 0 0 ~ 2 3 : 0 0

- The Mie Medical Information Centre (Mie ken Kyuukyuu Iryou Jouhou Center) can give you information about which hospitals are available in your area. Contact the centre on **TEL 0595-24-1199**

* After that, call the clinic/hospital to confirm opening hours and so on.

* When you go there, be sure to take your health insurance card/certificate.

* If you no longer need assistance, call the clinic or hospital to cancel your appointment.

- The hospitals on duty are for patients with serious injuries or illnesses who need specialist medical care or who need to be admitted to hospital.

* Only by referral from a medical facility, emergency consultant or taken by ambulance Shimin Byouin

* Not necessary to arrive by ambulance, but you must call ahead to say that you are on your way Okanami and Nabari

Hospitals

April						
Sun	Mon	Tues	Wed	Thurs	Fri	Sat
		1 Shimin	2 Okanami Nabari	3 Nabari	4 Shimin	5 Nabari
6 Nabari	7 Okanami	8 Nabari	9 Okanami Nabari	10 Nabari	11 Shimin	12 Shimin
13 Okanami	14 Okanami	15 Shimin	16 Okanami Nabari	17 Nabari	18 Shimin	19 Nabari
20 Nabari	21 Okanami	22 Nabari	23 Okanami Nabari	24 Nabari	25 Shimin	26 Shimin
27 Okanami	28 Okanami	29 Shimin	30 Okanami Nabari	Except pediatrics		

Hours:

Shimin & Nabari

Weekdays:

From 17:00 to 08:45 the following day

Saturdays, Sundays & Public holidays

From 08:45 to 08:45 the following day

Hospital Okanami

Mondays 17:00 to 09:00 the following day

Wednesdays 17:00 to 08:45 the following day

Sundays 09:00 to 08:45 the following day

* If Mondays or Wednesdays are public holidays, then from 09:00 to 08:45

Ueno Sougou Shimin Byouin

Tel 0595-24-1111

Okanami Sougou Byouin

Tel 0595-21-3135

Nabari Shiritsu Byouin

Tel 0595-61-1100

MIE CHILD HEALTH HOTLINE (みえ こども いりょう ダイアル)

Advice hotline for problems related to child insurance and health, such as illness, worries about child-rearing, vaccinations and so on. You will be able to speak to a pediatric doctor free of charge. Please feel free to make use of this service.

【Appropriate for】 Children less than 18 years of age or their family members

【Telephone & Times】 8 0 0 0 (059-232-9955) Every day from 19:00 to 23:30

Have you paid all your pension bills? (ねんきんのほけんりょうがみのもうになっていませんか?)

When you are finding it financially difficult to make pension payments due to having a very low income or being unemployed, it is possible to become exempt from having to make these payments. Until now the period that you could receive exemption for was up to one year from the July previous to your application (or April in the case of students). From April, you will be eligible for exemption from two years and one month from the time you apply. Exemption can come in various forms, such as full exemption, partial exemption ($\frac{3}{4}$, half or $\frac{1}{4}$), student exemptions etc.

You can apply for exemption for a total of up to two years one month of payments, but if payments are late, this may have an effect on payment of disability pension or bereaved family pension. Therefore, please be sure to file any paperwork with plenty of time. You will be vetted based on an assessment of your six month assessment, and may not always be deemed eligible for exemption. Please be aware of all the details and of what you need to submit before you apply.

【Applications & Enquiries】

Pensions Dept., Citizens' Welfare Dept. in every Branch Office, Tsu Pensions Office **TEL059-228-9188**

Look out for your carers Insurance Notification in the post

かいご ほけんりょう の つうちしょ を はっそうします

Notifications will be sent out to post for payment of carer's insurance fees for those who are over the age of 65 years old on April 11th. The amount written in the notification will be based on the insurance premium fees band that was calculated for you during the previous fiscal year. Your annual payment amount will be confirmed in July based on tax information from the municipal tax office for the current fiscal year. You will be contacted again with further information in July.

Enquiries: **Kaigo Kourei Fukushi Ka TEL 0595-26-3939 FAX 0595-26-3950**

Changes in the Financial Support for Fertility Treatment

ふいん ちりょう じょせい せいど

From April 1st, those who apply for the first time for this support will have a certain number of financial aid options available to them determined by their age. However, those who were already in receipt of this support as of March 31st 2014 will be able to continue receiving it under the same conditions until the end of the 2015 fiscal year. Please see the city's homepage for further details.

Enquiries: **Kenkou Suishin Ka TEL 0595-26-3939 FAX0595- 26-3950**

Advice & Counseling for Foreigners (がいこくじんのためのそつだん)

At City Hall, you can get advice relating to work problems, schools, health, insurance, retirement & pensions, child-rearing, housing, taxes, visas, or any other problems related to your day to day life. This service is free. If you have any problems or difficulties, don't leave them until later. Come to city hall for reliable, professional advice.

Day & time : Monday to Friday (except public holidays) from 9:00 to 17:00

Where : Ground floor of City Hall, in the **Shimin Seikatsu Ka** division **TEL 0595-22-9702**

There is another free service with an official agent for foreign residents, who can offer expert advice and help regarding public administration issues related to visas, marriages between foreigners, naturalising as a Japanese citizen and so on. In order to use this service you must make an appointment in advance. To do this, contact the Shimin Seikatsu Ka.

Time & date: 1st Thursday of every month (if this falls on a public holiday, the 2nd Thursday) from 1pm to 4pm.

Place : Ground floor of City Hall, in the **Shimin Seikatsu Ka** division **TEL 0595-22-9702**

Financial Support for Taxi etc Services for the Severely Disabled

じゅうど しょうがいしゃ タクシー ねんりょうひ の じょせい

Financial support is available for the transport costs of the severely disabled in order to ensure that they can fully contribute to society and also have easy access to hospital. This is available for either taxi fares, gasoline costs or for moped usage costs.

Eligibility: Anyone with one of the following certificates: *shintai shougaisha techou 1kyuu, 2kyuu; ryouiku techou A1, A2; seishinshougaisha hoken fukushi techou 1kyuu*

How to apply: Bring your disability certificate, personal seal, driver's licence and car registration (*shaken*) (in the case of a moped) and apply at the Disability Welfare Dept. or Citizen's Welfare Dept in any of the city hall branch offices.

Applications or Enquiries: **Shougai Fukushi Ka. TEL22-9656 FAX 22-9662**